

Installation Instruction for DZ962

page 1 of 1

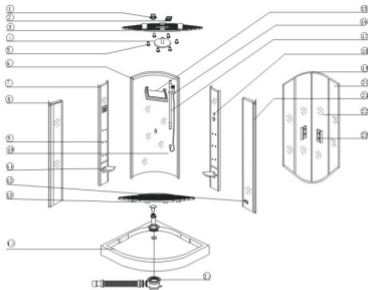

tools: monkey wrench, screw driver, Phillips screwdriver, level bar

Accessories: 4*10 round self-locking screw (30pcs), stainless steel clip (9pcs), 3mm flat washer (10pcs), 4mm screw nut (10pcs), 4*30 round self-locking screw (15pcs), 8* black rubber spacer (10pcs), screw (4 set)

1. speaker

2. ventilator

3. cover

4. ceiling shower

5. chromatherapy

6. medium shower wall

7. aluminum profile

8. left shower wall

9. jet

10. shower connector

11. movable seat

12. steam nozzle

13. pedal

14. aluminum alloy panel base

15. shampoo holder

16. hand shower

17. shower bar

18. faucet

19. track

20. fixed door

21. right shower wall

22. movable door

23. handle

24. drainage

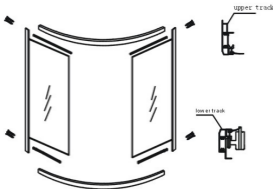

Installation procedure:

1. Fix the upper & lower tracks and the fixed glass door with M4*30 self-locking screw (the upper track should be installed on the longer side of the aluminum profile of the fixed glass door)

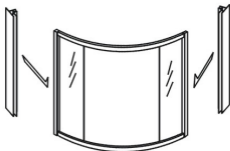

2. Put the fixed glass door into the extension profile. (Note: the open side of the extension aluminum profile should be adjusted flatly to the upper track of the fixed door frame, while holes of the corner aluminum profile should match the ones on the aluminum hole)



3. After the glass door and the glass wall are well connected, put the movable door on the fixed door frame, and fix the handle as illustrated.

Installation Illustration of The Movable Door

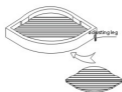

① ②

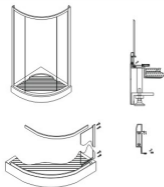

left shower wall

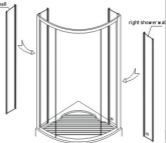

③ ④

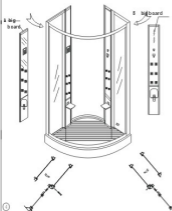

Installation Procedures:

- Put the tray flatly onto the floor, then put the pedal into the tray, make the tray parallel to the floor, (as illustrated in drawing 1)
- Connect the right fixed door frame and the lower track of the tray with 4*30 round self-locking screw, similarly for the left fixed door frame and the lower track, then fix the corner aluminum profile to the aluminum profile of the fixed left and right door. (as illustrated in drawing 2)
- Put the left and right glass wall into the corner aluminum profile, and fixed them with round self-locking screw. (as illustrated in drawing 3)
- Fix the A&B board and the left, right glass wall respectively. (as illustrated in drawing 4)

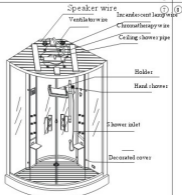
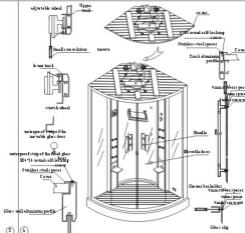
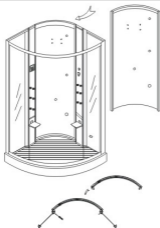

(ceiling shower pipe, lamp wire, speaker wire, ventilator illustration)

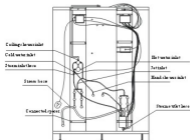

Installation Procedure:

5. put the medium back wall between A and B board, and fix them with round self-locking screw. (As illustrated in drawing 5)
6. fix the left, right movable door, handle, shower bar holder, glass clip, then put the cover on the top and screw down the cover with stainless steel dip and 4*10 round self-locking screw, then cover the decorated cover. (Note: adjust the left and right movable door with small screw drivers if they are not well close, as illustrated in drawing 6)
7. fix the ceiling shower inlet, lamp wire, speaker wire, ventilator wire, shower inlet, and holder. (As illustrated in drawing 7)
8. Fix the hose for jet, shower, steam inlet, steam, steam outlet, cold and hot water, then check the product again. (As illustrated in drawing 8)



Testing Illustration

**Installation procedure:**

9. Turn on the product and the water supply to check every function. (As illustrated in drawing 8)